

New York

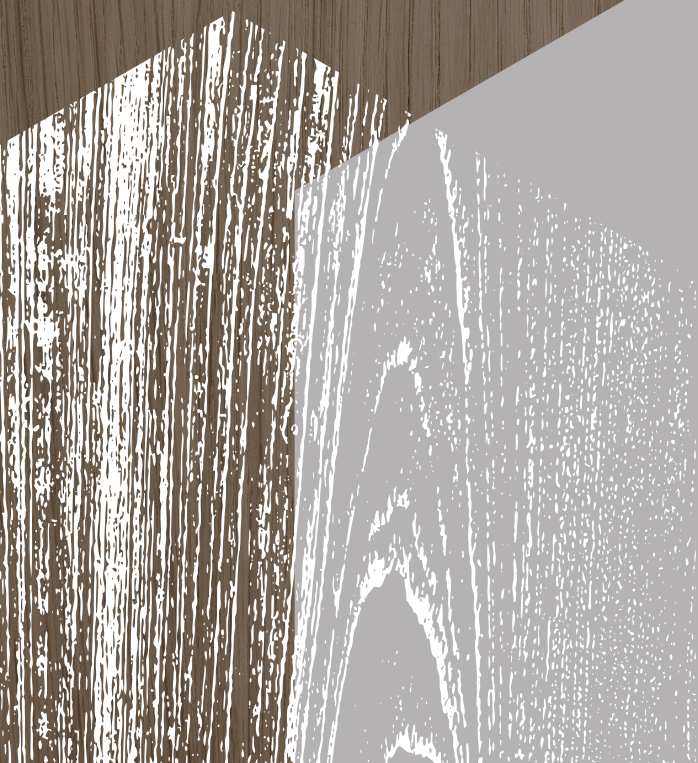

Steelcase

WorkLife New York Experience Guide

The Resilient Workplace Designing for Engagement

A real estate strategy founded on two core principals:

- 1. Design for Physical, Cognitive and Emotional Wellbeing**
- 2. Create an Ecosystem of Spaces**

1. Design for Physical, Cognitive and Emotional Wellbeing

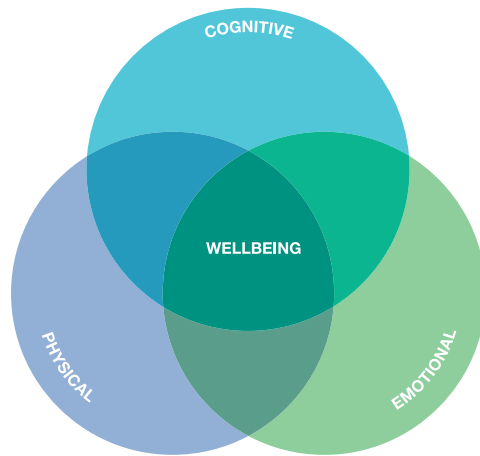

To foster employee engagement, the workplace needs to be designed to support employee wellbeing. The study explored broad dimensions of holistic wellbeing that address the physical, cognitive and emotional needs of people. These specific components of wellbeing are integral to employee satisfaction with their work environment and engagement.

When organizations understand this connection between wellbeing and engagement, it can inform and guide design direction for places that can impact engagement.

Designing workplaces to support the holistic wellbeing of people can amplify employee engagement and satisfaction.



Physical: Be Healthier

Support movement throughout the day and encourage healthy postures that help people stay comfortable and energized.



Cognitive: Think Better

Support the need for focus and rejuvenation through spaces where individuals and teams can think clearly, concentrate easily, solve problems and generate new ideas.



Emotional: Feel Better

Support the social nature of work by creating spaces that nurture a sense of belonging and foster connections and foster connections between people and the organization.

2. Create an Ecosystem of Spaces

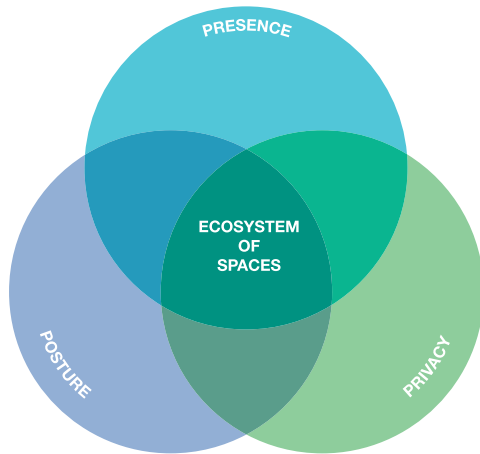

People at work need to focus, collaborate, rejuvenate, socialize and learn throughout their day. No single type of space can effectively support the diverse needs of individuals and groups. The workplace should be designed as an **ecosystem of interconnected zones and settings** that are destinations where people have choice and control over where and how they work.

An ecosystem of spaces enables an organization to be more resilient. It uses real estate more efficiently and cost-effectively, making it easier for organizations to experiment with different types of spaces and evolve the workplace over time.

A workplace ecosystem supports employee wellbeing by providing individuals and groups with a range of options within the workplace that consider the following:



Posture: Movement + Variety

The workplace should encourage regular movement throughout the day and offer options for people to work in sitting, standing or lounge postures.



Presence: Digital + Analog Physical + Virtual

Spaces should enable quality interactions with teams that are both local and distributed across continents and time zones, supporting both digital and analog communication.



Privacy: Focus + Rejuvenation

The work environment should provide places that offer varying ways to achieve privacy, in both open and enclosed spaces. Privacy is important to all workers and a vital component of both focus and rejuvenation, which are essential to employee engagement.

WorkLife New York

12	Floor plan	41	Setting Q Focus Studio
14	Setting B.2 Reception	42	Setting O Meeting on Demand
16	Setting B.3 Hospitality	44	Setting N Private Office
17	Setting Z.1 Ancillary Welcome	46	Setting M Conference Room
18	Setting Y Nomadic Bench	48	Setting L Virtual Meeting
19	Setting X Lounge Meeting	50	Setting A Sandbox
20	Setting V.3 Agile Bench	51	Setting G.1 Nomadic Touchdown
22	Setting W.2 Shared Exploration	52	Setting G.2 Resource Centre
24	Setting V.2 Comfortable Connections	53	Setting F Host + Play Big Table
25	Setting V.1 Resident 8x8	54	Setting E Host + Play Lounge
26	Setting W.1 Focused Nomad + Respite	56	Setting K.1 & K.2 Office Front Alternative
28	Setting C.1 Seating Experience	57	Setting K.2 Resident Office
29	Setting C.2 Nuts + Bolts Thread	58	Setting K.1 Dual Purpose Office
30	Setting D.1 Dyadic Studio	60	Setting J Open Plan Workstation
32	Setting D.2 Generative Meeting Space	62	Setting H.2 Executive Office
34	Setting U.1 Duo Studio	64	Setting H.1 Meeting Space
36	Setting U.2 Ideation Hub	66	Setting U.3 Height Adjustable Executive Office
38	Setting T Maker Commons	68	Index
39	Setting R Focus Studio		
40	Setting S Respite		

WorkLife New York

FLOOR PLAN

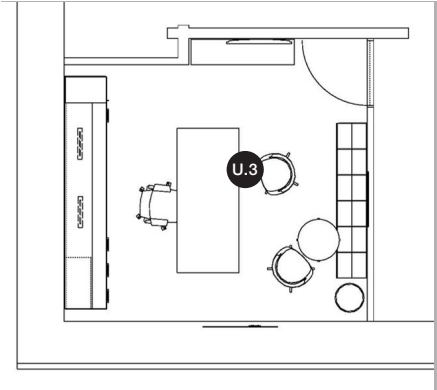

6TH FLOOR

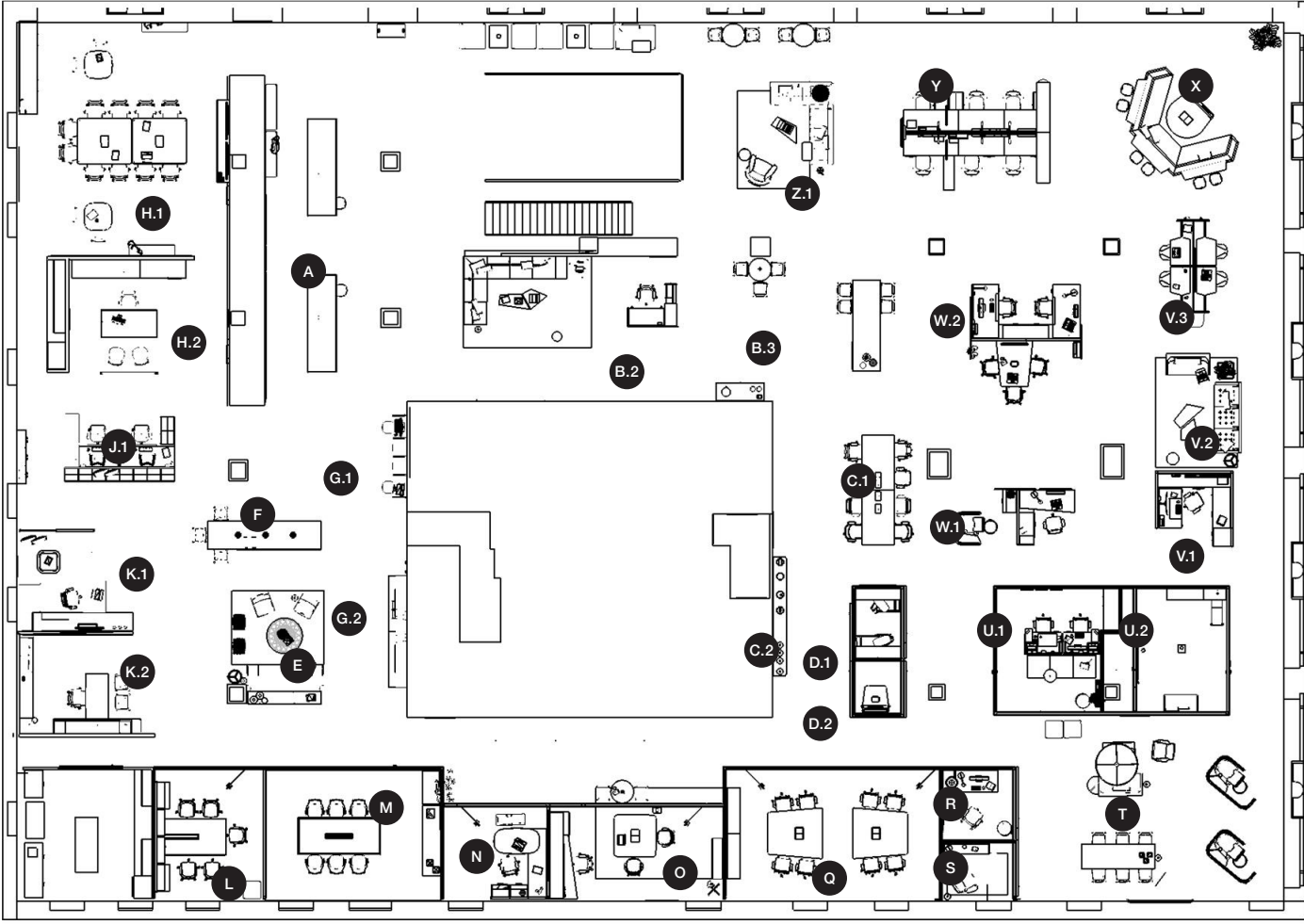

7TH FLOOR

WorkLife New York

SETTING B.2 | RECEPTION

The welcome desk is an expression of our product and design language. The standing-height welcome desk maintains eye to eye connectivity between the host and guest.

The veneer surround is crafted with a biophilic design that highlights the vertical grain of this natural material.

The area is located adjacent to the café to provide easy access to hospitality.



TYPE OF WORK SUPPORTED

Focus

Collaborate

Rejuvenate

Socialize

Learn

POSTURE

Lounge

Sit

Stand

Walk

PRESENCE

Physical

Virtual

Analog

Digital

PRIVACY

Enclosed

Shielded

Open



WorkLife New York

SETTING B.3 | HOSPITALITY

A welcoming space located close to the entrance provides hospitality and a comfortable place to meet or socialize with visitors or colleagues. The standing-height tables encourage quick connections and information sharing.

A diverse use of materials creates an authentic, comfortable space that draws users in.



TYPE OF WORK SUPPORTED

Focus

Collaborate

Rejuvenate

Socialize

Learn

POSTURE

Lounge

Sit

Stand

Walk

PRESENCE

Physical

Virtual

Analog

Digital

PRIVACY

Enclosed

Shielded

Open

WorkLife New York

SETTING Z.1 | ANCILLARY WELCOME

This centrally-located spot supports customer hosting in an informal and comfortable atmosphere. This application provides employees and visitors with an inspiring space where they can easily connect, socialize or complete a few tasks while transitioning from one meeting or activity to the next.

The thoughtfully curated solution blends modern and mid-century pieces with a fun mixture of materials without compromising performance.



TYPE OF WORK SUPPORTED

Focus

Collaborate

Rejuvenate

Socialize

Learn

POSTURE

Lounge

Sit

Stand

Walk

PRESENCE

Physical

Virtual

Analog

Digital

PRIVACY

Enclosed

Shielded

Open

WorkLife New York

SETTING Y | NOMADIC BENCH

This area supports nomadic workers and provides them a place to connect with content and their peers. The monitor is visible to all at the bench and everyone has equal access from their location, thus creating connections and supporting creative thinking.

FrameOne paired with different storage options creates a highly efficient and comfortable space in a compressed footprint. The storage with cushion top provides a place for impromptu guests.

The texture of the upholstery, the cheerful, modest print and the rustic aesthetic of the plank wood layer together to create an inspiring destination where people want to work.



TYPE OF WORK SUPPORTED

Focus
Collaborate
Rejuvenate
Socialize
Learn

POSTURE

Lounge
Sit
Stand
Walk

PRESENCE

Physical
Virtual
Analog
Digital

PRIVACY

Enclosed
Shielded
Open

WorkLife New York

SETTING X | LOUNGE MEETING

A dynamic and scalable collaborative meeting space. The lounge with shared technology democratize how people access and share information by allowing all participants to contribute their ideas — equally, quickly and seamlessly — by removing barriers to participation. The infield seating has direct access to share and display content. The outfield stool-based seating has the ability to support additional participants with equal visual access to the display.

The lounge posture creates a relaxed, comfortable environment, while tools support working and sharing of digital content.



TYPE OF WORK SUPPORTED

Focus
Collaborate
Rejuvenate
Socialize
Learn

POSTURE

Lounge
Sit
Stand
Walk

PRESENCE

Physical
Virtual
Analog
Digital

PRIVACY

Enclosed
Shielded
Open

WorkLife New York

SETTING V.3 | AGILE BENCH

This nomadic destination comfortably supports the flow from individual focused work to collaborative group interactions. Postural changes from seated to standing can be made quickly without having to adjust the furniture; the angles of the surface allows users to work comfortably in both seated and standing postures.

Open storage for personal belongings and access to power at the surface gives users easy access to the resources they need.

The dark metallic and plank walnut surface with visible grain and color variations creates an urban aesthetic and an overall informal and comfortable feel.



TYPE OF WORK SUPPORTED

Focus

Collaborate

Rejuvenate

Socialize

Learn

POSTURE

Lounge

Sit

Stand

Walk

PRESENCE

Physical

Virtual

Analog

Digital

PRIVACY

Enclosed

Shielded

Open



WorkLife New York

SETTING W.2 | SHARED EXPLORATION

A dedicated space for residents provides worktools and seating privacy for focused work. Answer panels provide efficient space division and delivery of utilities. The boundary panel provides a light scale alternative to a traditional panel when only simple space division is required. Height adjustable worksurfaces encourage healthy posture changes.

Adjacent open meeting area supports impromptu meetings within the resident zone. The media:scape application enables content sharing and generation, plus easy access to power. Users can quickly gather and immediately begin to collaborate and co-create.



TYPE OF WORK SUPPORTED

Focus

Collaborate

Rejuvenate

Socialize

Learn

POSTURE

Lounge

Sit

Stand

Walk

PRESENCE

Physical

Virtual

Analog

Digital

PRIVACY

Enclosed

Shielded

Open



WorkLife New York

SETTING V.2 | COMFORTABLE CONNECTIONS

This living room-like setting is a comfortable, quiet space for employees to pause and rejuvenate or collaborate in a relaxed posture. Here, workers can remove themselves from the busyness of the day, collect their thoughts, or share ideas with a co-worker.

The mix of pieces and use of natural textures, rich colors and finishes make the work experience more human-centered. Sustainable materials that perform, and hold up to the demands of the workplace, help create a space people want to work in.



TYPE OF WORK SUPPORTED

Focus
Collaborate
Rejuvenate
Socialize
Learn

POSTURE

Lounge
Sit
Stand
Walk

PRESENCE

Physical
Virtual
Analog
Digital

PRIVACY

Enclosed
Shielded
Open

WorkLife New York

SETTING V.1 | RESIDENT 8X8

This space allows residents access to appropriate work tools to support heads-down, focused work. Low panels offer a boundary while keeping views and access to coworkers.

Height-adjustable desks allow users to change postures throughout the day, supporting movement that boosts individual energy levels and leads to greater engagement.

The rail can support worktools, monitor arms, lighting and privacy/modesty screens, which allow the desk to be customized based on a user's specific needs and workstyle, and can easily be changed over time.



TYPE OF WORK SUPPORTED

Focus
Collaborate
Rejuvenate
Socialize
Learn

POSTURE

Lounge
Sit
Stand
Walk

PRESENCE

Physical
Virtual
Analog
Digital

PRIVACY

Enclosed
Shielded
Open

WorkLife New York

SETTING W.1 | FOCUSED NOMAD + RESPITE

The nomadic zone supports the broad range of mobile user needs in the workplace. The Brody WorkLounge area is a casual place where nomadic workers can connect with their technology, perform task work or find a quiet moment alone. Individual focus space with a view of an inspiring and stimulating visual allows users to escape and rejuvenate without leaving the building.

The workstation comfortably supports focused work and provides power access and a place for personal belongings.

The use of natural materials makes this work experience more human-centered and creates a more authentic aesthetic.



TYPE OF WORK SUPPORTED

Focus

Collaborate

Rejuvenate

Socialize

Learn

POSTURE

Lounge

Sit

Stand

Walk

PRESENCE

Physical

Virtual

Analog

Digital

PRIVACY

Enclosed

Shielded

Open



WorkLife New York

SETTING C.1 | SEATING EXPERIENCE

This area is designed for users to engage and experience our seating story. Visitors are able to test drive our desk chairs, discover the details around product inspiration, learn insights about supporting the body and mind at work, and discover how these inspirations merge and come to life in our different lines.

The long veneer table supports an active sitting experience. This area can also host a medium-size collaborative working session.

The black upholstery provides a neutral palette and creates a unified aesthetic for this area.



TYPE OF WORK SUPPORTED

Focus

Collaborate

Rejuvenate

Socialize

Learn

POSTURE

Lounge

Sit

Stand

Walk

PRESENCE

Physical

Virtual

Analog

Digital

PRIVACY

Enclosed

Shielded

Open

WorkLife New York

SETTING C.2 | NUTS + BOLTS THREAD

Thread is a power solution unlike any other, and its true value is in what it enables — connection. This application is created to help visitors fully experience the product.

The physical displays features the product along with a virtual demonstration of Thread in an animation run on the monitor.

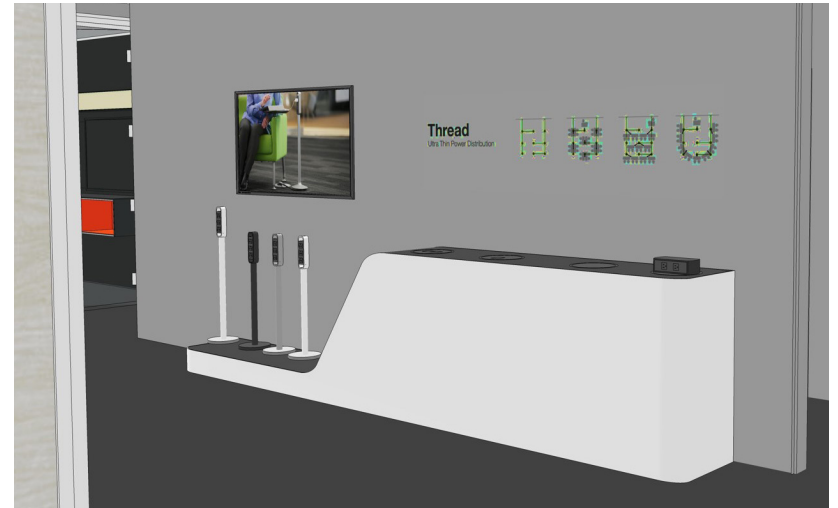

TYPE OF WORK SUPPORTED

Focus

Collaborate

Rejuvenate

Socialize

Learn

POSTURE

Lounge

Sit

Stand

Walk

PRESENCE

Physical

Virtual

Analog

Digital

PRIVACY

Enclosed

Shielded

Open

WorkLife New York

SETTING D.1 | DYADIC STUDIO

An informal destination to connect and share information. The individual lounges create a relaxed, comfortable environment for one or two to share. The space supports confidential content sharing on the wall-mounted monitors that are thoughtfully placed to promote face-to-face connections.

The warm and calming palette creates a casual atmosphere ideal for sharing stories and generating ideas.



TYPE OF WORK SUPPORTED

Focus

Collaborate

Rejuvenate

Socialize

Learn

POSTURE

Lounge

Sit

Stand

Walk

PRESENCE

Physical

Virtual

Analog

Digital

PRIVACY

Enclosed

Shielded

Open

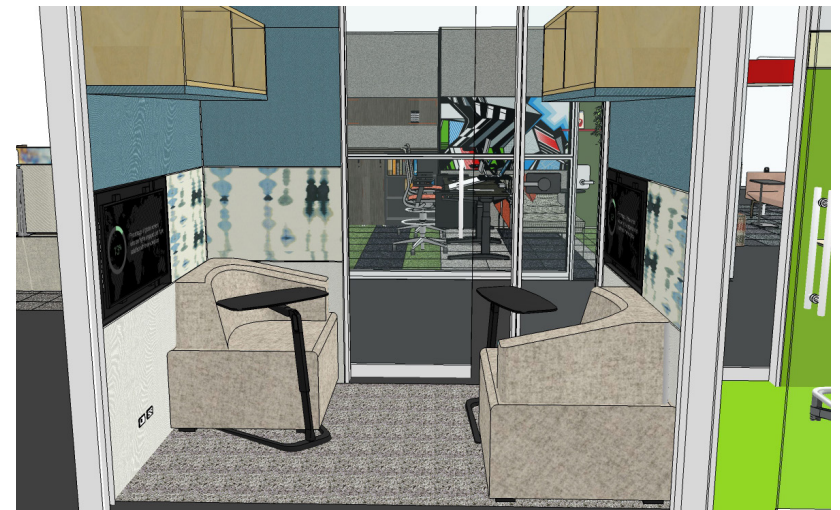

WorkLife New York

SETTING D.2 | GENERATIVE MEETING SPACE

This acoustically-sound setting houses a media:scape kiosk, creating a high-definition videoconferencing setting optimized for one or two people.

Integrated V.I.A. lighting automatically turns on when entering, delivering the optimal lighting for video conferencing.

The orientation of the kiosk helps to block visual distractions but also lets users be aware of their surroundings, while capturing the whiteboard (analog) content behind.

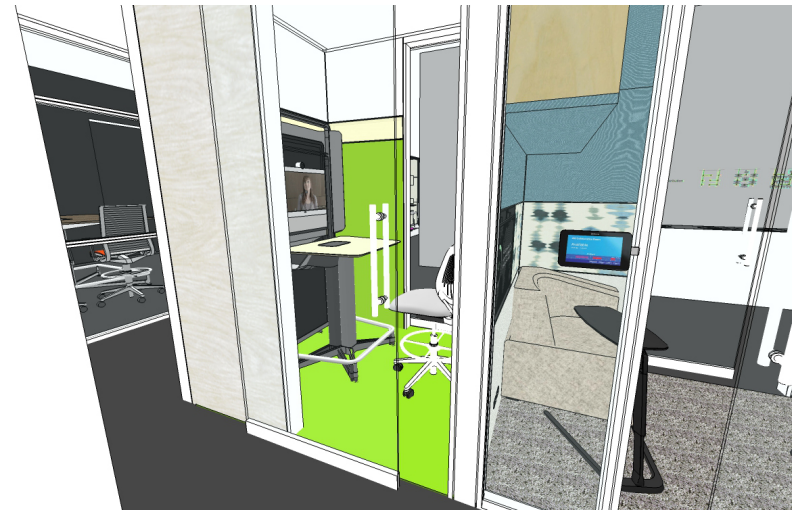

TYPE OF WORK SUPPORTED

Focus

Collaborate

Rejuvenate

Socialize

Learn

POSTURE

Lounge

Sit

Stand

Walk

PRESENCE

Physical

Virtual

Analog

Digital

PRIVACY

Enclosed

Shielded

Open



WorkLife New York

SETTING U.1 | DUO STUDIO

Working in pairs is an essential behavior of creativity. This space supports a trust relationship in which two people can co-create, while also supporting individual work. Ology height-adjustable desks are side-by-side, making it easy to sit or stand, work individually in parallel or lean over to collaborate, maintaining flow and consistency using Surface Studio.

It includes a lounge area to invite others in for a quick creative review or put your feet up and get away without going away. Umami lounge also offers a place to relax and re-energize during intense work sessions.



TYPE OF WORK SUPPORTED

Focus

Collaborate

Rejuvenate

Socialize

Learn

POSTURE

Lounge

Sit

Stand

Walk

PRESENCE

Physical

Virtual

Analog

Digital

PRIVACY

Enclosed

Shielded

Open



WorkLife New York

SETTING U.2 | IDEATION HUB

This space is a high-tech destination that encourages active participation and equal opportunity to contribute as people co-create, refine and share ideas with co-located or distributed teammates.

Stool-height seating encourages movement and quick shifts from interaction with personal devices to group collaboration at the Surface Hub.

The furniture elements are scaled to allow ample circulation and the ability to engage or step back from the action and reflect or gain a different perspective.

TYPE OF WORK SUPPORTED

Focus

Collaborate

Rejuvenate

Socialize

Learn

POSTURE

Lounge

Sit

Stand

Walk

PRESENCE

Physical

Virtual

Analog

Digital

PRIVACY

Enclosed

Shielded

Open

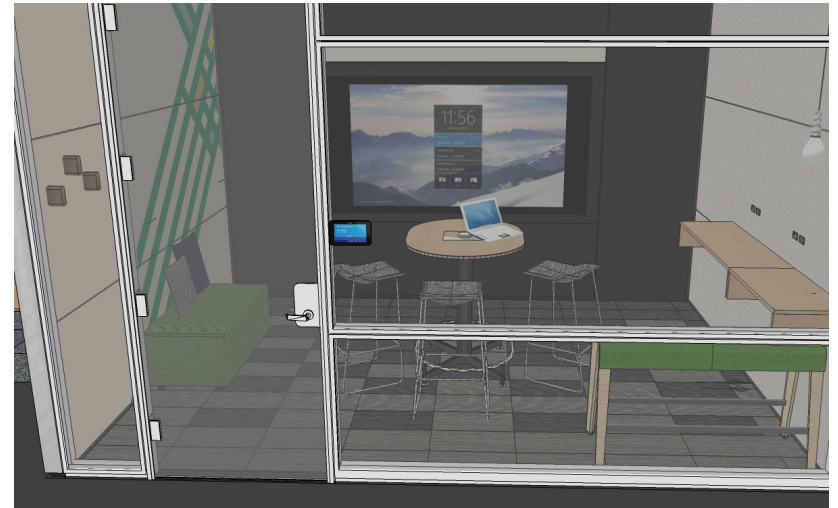

WorkLife New York

SETTING T | MAKER COMMONS

Socializing ideas and rapid prototyping are essential parts of creativity. This space is designed to encourage quick switching between conversation, experimentation and concentration.

This space supports a full range of postures — seated, standing, lounging and perching — encouraging movement without breaking flow.

This space has a communal atmosphere to gather and play with new ideas. The integrated Surface Hub allows people to shift easily from “me” to “we” activities and through the different stages of the creative process. Adjacent Brody WorkLounge supports quiet reflection and city views.



TYPE OF WORK SUPPORTED	POSTURE	PRESENCE	PRIVACY
Focus	Lounge	Physical	Enclosed
Collaborate	Sit	Virtual	Shielded
Rejuvenate	Stand	Analog	Open
Socialize	Walk	Digital	
Learn			

WorkLife New York

SETTING R | FOCUS STUDIO

Individual creative work requires places for alone time to focus and get into flow, while also allowing quick shifts to two-person collaboration. It's a place to let ideas incubate before sharing them with the group.

This space is configured to keep information private and reduce visual distraction. The Airtouch desk lifts with a touch to switch quickly and effortlessly from sitting to standing — encouraging movement and boosting energy. The desk also facilitates brief, shoulder-to-shoulder collaboration so people can easily share content from their Surface Pro 4 or Surface Book.



TYPE OF WORK SUPPORTED	POSTURE	PRESENCE	PRIVACY
Focus	Lounge	Physical	Enclosed
Collaborate	Sit	Virtual	Shielded
Rejuvenate	Stand	Analog	Open
Socialize	Walk	Digital	
Learn			

WorkLife New York

SETTING S | RESPITE

Creative work requires many thinking modes. This space allows people to balance active group work with solitude and individual think time.

Relaxed postures can help support diffused attention, allow the brain to wander, and lead to “eureka” insights. It also supports active brainstorming while away from your personal workstation allowing quick switches between typing and working with digital ink or touch.

Thread modular power makes it easy to charge devices. The ottoman opens to provide a place to store personal items.



TYPE OF WORK SUPPORTED

Focus
Collaborate
Rejuvenate
Socialize
Learn

POSTURE

Lounge
Sit
Stand
Walk

PRESENCE

Physical
Virtual
Analog
Digital

PRIVACY

Enclosed
Shielded
Open

WorkLife New York

SETTING Q | TEAM STUDIO

media:scape TeamStudio is designed to support active project teams. Physical and virtual barriers are removed, allowing participants to freely engage with both analog and digital tools. The space creates an environment optimized for active collaboration.

TeamStudio transforms quickly and can easily host a large team brainstorming session or a small breakout session. media:scape technology connects local and globally distributed teams, amplifying collaboration to accelerate innovation.



TYPE OF WORK SUPPORTED

Focus
Collaborate
Rejuvenate
Socialize
Learn

POSTURE

Lounge
Sit
Stand
Walk

PRESENCE

Physical
Virtual
Analog
Digital

PRIVACY

Enclosed
Shielded
Open

WorkLife New York

SETTING O | MEETING ON DEMAND

Designed for the mobile leader, this private office supports the importance of collaboration and team building. Access to technology enables connections with distributed teams and provides a destination for evaluating work and generating solutions together.

When the space is unoccupied, it transforms into a reservable high-performance team space outfitted with media:scape technology and ample whiteboards for analog co-creation and HDVC for remote participation.

A space for a short-term interaction either before or after a meeting is conveniently positioned outside the space, supporting workflow and building connections.



TYPE OF WORK SUPPORTED

Focus

Collaborate

Rejuvenate

Socialize

Learn

POSTURE

Lounge

Sit

Stand

Walk

PRESENCE

Physical

Virtual

Analog

Digital

PRIVACY

Enclosed

Shielded

Open



WorkLife New York

SETTING N | PRIVATE OFFICE

Individuals and groups require varying levels of stimulus and privacy throughout the work day. Access and proximity to enclosed spaces is needed by all. This free address private space environment is ideal for working alone or sharing and discussing content with confidence. An enclosed room creates a trusted environment for users to engage in deep conversation with a colleague. A writable surface enables users to quickly share thoughts and ideas. The work table supports the users' materials with a secondary surface for personal items.



TYPE OF WORK SUPPORTED

Focus

Collaborate

Rejuvenate

Socialize

Learn

POSTURE

Lounge

Sit

Stand

Walk

PRESENCE

Physical

Virtual

Analog

Digital

PRIVACY

Enclosed

Shielded

Open

WorkLife New York

SETTING M | CONFERENCE ROOM

This high-performance meeting space supports technology use for all participants. A center trough in the table has access to power and technology to support the devices that workers bring to collaborate. Virtual PUCK allows users to position themselves anywhere in the space and still be able to share content on-screen.

Integrated storage keeps collaboration tools accessible. A bench at the entrance and a standing-height table directly (shown outside setting O) beside the space supports transitions before and after meetings.

Sophisticated surface materials and finishes create an elegant aesthetic without compromising on functionality.



TYPE OF WORK SUPPORTED

Focus

Collaborate

Rejuvenate

Socialize

Learn

POSTURE

Lounge

Sit

Stand

Walk

PRESENCE

Physical

Virtual

Analog

Digital

PRIVACY

Enclosed

Shielded

Open



WorkLife New York

SETTING L | VIRTUAL MEETING

This enclosed space supports small team focused collaboration and larger distributed team meetings via videoconference.

Horizontal and vertical surfaces provide analog content display and a platform for brainstorming and ideation that can easily be viewed for the remote participants.

media:scape supports digital content sharing and fluid collaboration. Videoconferencing connects distributed teams while the wall mounted table easily accommodates users comfortably.



TYPE OF WORK SUPPORTED

Focus

Collaborate

Rejuvenate

Socialize

Learn

POSTURE

Lounge

Sit

Stand

Walk

PRESENCE

Physical

Virtual

Analog

Digital

PRIVACY

Enclosed

Shielded

Open



WorkLife New York

SETTING A | SANDBOX

The “sand box” allows customers to discover ways to express their brand and culture with materiality.

The large surfaces can also be a hosting destination for a more immersive event experience. This area features our Designtex brand and our global surface materials palette.

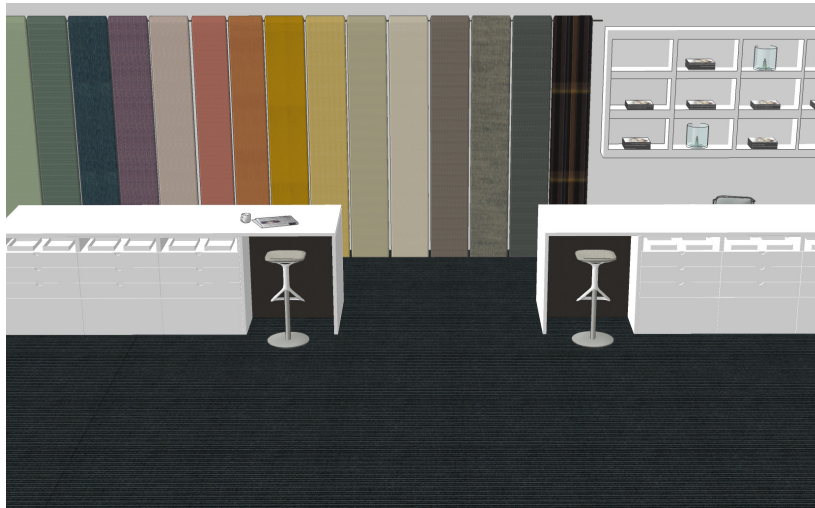

TYPE OF WORK SUPPORTED

Focus

Collaborate

Rejuvenate

Socialize

Learn

POSTURE

Lounge

Sit

Stand

Walk

PRESENCE

Physical

Virtual

Analog

Digital

PRIVACY

Enclosed

Shielded

Open

WorkLife New York

SETTING G.1 | NOMADIC TOUCHDOWN

This space supports nomadic users and provides the opportunity to do quick-connect focus work. Located in a central spot and close to the resource center, mobile users can engage with their own technology or connect to the shared monitor. Surface-height power and data enables seamless connectivity. The shared storage creates another surface to rest personal belongings, and the drawers house commonly required supplies.

The FlexFrame application has a mix of veneer and glass surfaces. The glass lightens the application visually and can communicate commonly-needed team or organizational information.



TYPE OF WORK SUPPORTED

Focus

Collaborate

Rejuvenate

Socialize

Learn

POSTURE

Lounge

Sit

Stand

Walk

PRESENCE

Physical

Virtual

Analog

Digital

PRIVACY

Enclosed

Shielded

Open

WorkLife New York

SETTING G.2 | RESOURCE CENTRE

The resource area offers a one-stop access to printers, shared reference materials and supplies. Users have easy access to all of the items they need to accomplish their work.

The long veneer surface supports content to be arrayed and sorted. The double-high storage units with back painted glass doors enables visual messaging and team communications.

This application has a tailored feel with eclectic use of wood, glass and laminate demonstrating how materials can be mixed to communicate brand.



TYPE OF WORK SUPPORTED

Focus

Collaborate

Rejuvenate

Socialize

Learn

POSTURE

Lounge

Sit

Stand

Walk

PRESENCE

Physical

Virtual

Analog

Digital

PRIVACY

Enclosed

Shielded

Open

WorkLife New York

SETTING F | HOST + PLAY BIG TABLE

This space illustrates real estate optimization with the shared storage also supporting casual working and meeting. It can support users as a nomadic touchdown or a front porch for impromptu meetings. This area can easily adapt into a café space that supports light hospitality.

The rustic plank wood reflects the informal nature of the space and helps convey a warm feeling that promotes conversation and learning, and builds a sense of community. The large surface provides space to display materials and assets that are stored here. Thread brings power to the space, supporting users and their technology.



TYPE OF WORK SUPPORTED

Focus

Collaborate

Rejuvenate

Socialize

Learn

POSTURE

Lounge

Sit

Stand

Walk

PRESENCE

Physical

Virtual

Analog

Digital

PRIVACY

Enclosed

Shielded

Open

WorkLife New York

SETTING E | HOST + PLAY LOUNGE

This centrally-located meeting space allows people to easily connect with each other or work alone in a comfortable posture. Social space supports the ebb and flow as people transition from one location to another.

Accessibility offers the opportunity for those in private spaces to meet and have impromptu encounters with other users in the organization or visitors to the area, highlighting the balance between private and collaborative work modes. The shielded experience minimizes distraction and creates a warm and welcoming space.

This thoughtfully curated solution blends mid-century modern lounge pieces with natural materiality and the performance to support the demands of a busy office.



TYPE OF WORK SUPPORTED

Focus

Collaborate

Rejuvenate

Socialize

Learn

POSTURE

Lounge

Sit

Stand

Walk

PRESENCE

Physical

Virtual

Analog

Digital

PRIVACY

Enclosed

Shielded

Open



WorkLife New York

SETTING K.1 & K.2 | OFFICE FRONT ALTERNATIVE

In an enclosed space workers can obtain the highest level of control over stimuli, information and the ability to adjust the space to their personal preferences. These office applications should be imagined fully enclosed. This space is meant to allow visitors to fully engage and experience the environment without the physical boundaries of the walls.

These spaces reflect the trend how ownership of private offices is changing. The K.1 office is an owned resident space whereas K.2, with the use of the RoomWizard, reflects an opportunity for the space to be reserved or shared by others, such as a single user requiring focus or a small team requiring a space to meet.



TYPE OF WORK SUPPORTED	POSTURE	PRESENCE	PRIVACY
Focus	Lounge	Physical	Enclosed
Collaborate	Sit	Virtual	Shielded
Rejuvenate	Stand	Analog	Open
Socialize	Walk	Digital	
Learn			

WorkLife New York

SETTING K.2 | RESIDENT OFFICE

This resident office is designed to support creativity and inspire the primary user and guest. The office is zoned to support deep focus as well as collaboration. The long chalkboard supports analog brainstorming and sharing with a tactile surface that is reminiscent of youthful creativity. The wool tackable board provides the owner with the opportunity to personalize the space and share inspirations or information.

Workwall supports anticipated and archival storage needs, with a magnetic writable glass back surface to support quick notes and reminders. The teak composite grain runs horizontal which creates visually pleasing lines and elongates the plane. The glass, open cubbies and the use of a leg base provide a lighter more modern feeling.



TYPE OF WORK SUPPORTED	POSTURE	PRESENCE	PRIVACY
Focus	Lounge	Physical	Enclosed
Collaborate	Sit	Virtual	Shielded
Rejuvenate	Stand	Analog	Open
Socialize	Walk	Digital	
Learn			

WorkLife New York

SETTING K.1 | DUAL-PURPOSE OFFICE

This dual-purpose office supports organizations with a high-percentage of nomadic workers. The office can be booked remotely or on demand. The space is designed to support working alone or together, at a desk height or lounge posture.

Storage accommodates the needs of a mobile worker by providing open areas for personal resources and spaces for shared materials. A large monitor is activated by the media:scape Virtual PUCK, which supports content sharing.

Solid and wood laminate combine with felt wall covering and soft plaid to create a warm and soothing environment.



TYPE OF WORK SUPPORTED

Focus

Collaborate

Rejuvenate

Socialize

Learn

POSTURE

Lounge

Sit

Stand

Walk

PRESENCE

Physical

Virtual

Analog

Digital

PRIVACY

Enclosed

Shielded

Open

WorkLife New York

SETTING J | OPEN PLAN WORKSTATION

A dedicated space for residents that supports workflow from private uses to collaboration with others. The space is located near the private offices to facilitate support for those occupants and provide unobstructed sight lines. The dual station is equipped with height-adjustable surfaces that encourage healthy posture change.

Storage is positioned for easy access as well as creating a boundary for added privacy. It can also accommodate a visitor seated on the cushion on one side or standing collaboration on the other. The floating storage units houses archival and shared resources and supports impromptu meetings or a moment of respite. Adjacent lockers provide a place to securely store personal belongings.

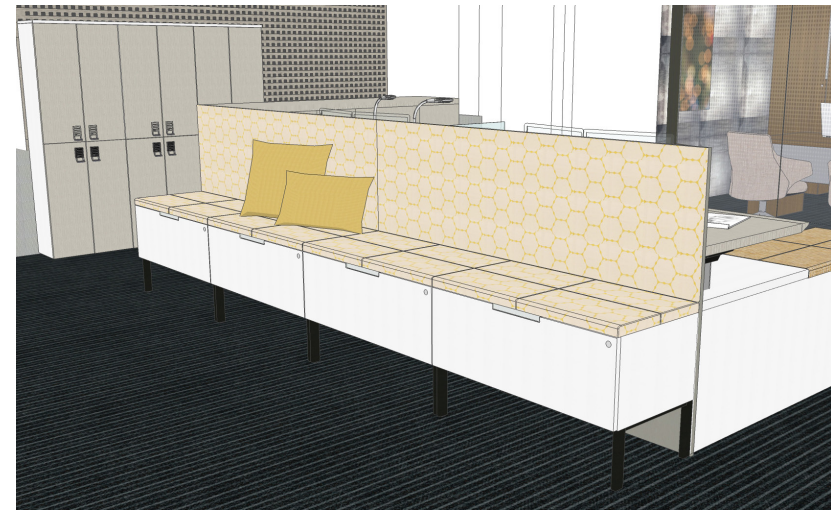

TYPE OF WORK SUPPORTED

Focus

Collaborate

Rejuvenate

Socialize

Learn

POSTURE

Lounge

Sit

Stand

Walk

PRESENCE

Physical

Virtual

Analog

Digital

PRIVACY

Enclosed

Shielded

Open



WorkLife New York

SETTING H.2 | EXECUTIVE OFFICE

This private office supports leaders doing focused work and collaborating with their teams. Individual work can be performed on the large front desk or on the surface of the storage wall. Layered surfaces create a space for anticipated work and files to be close at hand and accessible.

Open and closed storage bins with glass doors provide access to supplies and personal belongings while helping keep the area clutter-free.

The materiality of the space provides a residential sensibility that balances luxury and utility. The mix of finishes, such as the magnetic glass and quarter-cut walnut in a low sheen, modernize the traditional idea of an executive space.



TYPE OF WORK SUPPORTED

Focus

Collaborate

Rejuvenate

Socialize

Learn

POSTURE

Lounge

Sit

Stand

Walk

PRESENCE

Physical

Virtual

Analog

Digital

PRIVACY

Enclosed

Shielded

Open



WorkLife New York

SETTING H.1 | MEETING SPACE

This space creates a dynamic meeting experience by encouraging movement, supporting a range of postures and allowing users to easily share digital or analog content. The layered approach to the space supports small groups and large equally. Standing-height tables allow participants the freedom to choose a seated or standing posture.

Multiple displays enable participants to view and compare information with ease. Users can share digital content from their laptop on the large displays with the touch of a puck.

The wall-mounted storage and front credenza provides ample space for food and beverage for hosting and low storage with cushions provides additional seating.



TYPE OF WORK SUPPORTED

Focus

Collaborate

Rejuvenate

Socialize

Learn

POSTURE

Lounge

Sit

Stand

Walk

PRESENCE

Physical

Virtual

Analog

Digital

PRIVACY

Enclosed

Shielded

Open



WorkLife New York

SETTING U.3 | HEIGHT ADJUSTABLE EXECUTIVE OFFICE

This high-performing executive private office supports varied work modes. The focus area offers ample storage, guest seating and a height-adjustable surface. Although the desk may look like a traditional piece, built-in storage encloses the adjustable legs and enables a range of motion and movement.

The lounge space provides a place for respite and to host informal meetings in a setting that encourages open discussion.

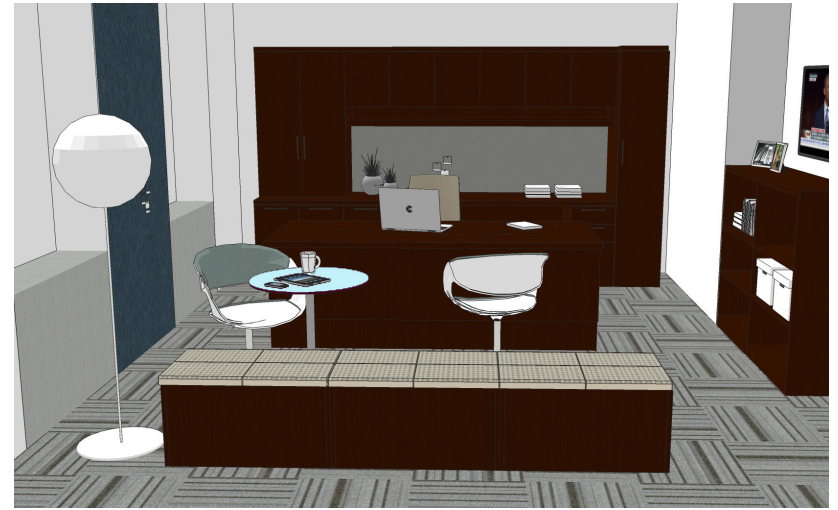

TYPE OF WORK SUPPORTED

Focus

Collaborate

Rejuvenate

Socialize

Learn

POSTURE

Lounge

Sit

Stand

Walk

PRESENCE

Physical

Virtual

Analog

Digital

PRIVACY

Enclosed

Shielded

Open



Index

PRODUCTS & FINISHES



SETTING B.2

AIR TOUCH DESK

Top: 2883 Seagull laminate
Base: 4799 Platinum

BOUNDARY SCREEN

Finish: 3F8X European Walnut with custom graphics applied

GESTURE SEATING

Wrapped back stool
Scheme: Dark/dark
Seat and back: Designtex Mingle Fog 3491-803

HD STORAGE

Configuration: Shelf/Coat closet
Case: 3F8X European Walnut
Inner: 7278 Dark Bronze
Pull: Jazz 9201 Polished Chrome
Magnetic Board: Billiard 5H21 Gunmetal

TECHNOLOGY

USB power strip



SETTING B.3

ELECTIVE ELEMENTS BIG TABLE

Top: 2730 Arctic White laminate
Modesty: Applied graphic

ELECTIVE ELEMENTS STORAGE

2730 Arctic White laminate

MONTARA650 CAFE TABLE

Base: 4146 Champagne Matte
Top: Oak to match VP01

MONTARA650 STOOLS

Upholstered seat wood back
Base: 4B23 Burnished Bronze
Back: VP01 Light Oak
Seat: Designtex Heather 3473-801 Gull Grey

VICTOR

2730 Arctic White
7241 Arctic White

Index

PRODUCTS & FINISHES



SETTING Z.1

ALIGHT OTTOMAN

Digitally printed fabric

AREA RUG

Peace industry zipper rug

AWAIT TABLE

Clear glass with applied film to underside

CH468 OCULUS CHAIR

Designtex Heather 3473-105 Walnut

LAGUANITAS PERSONAL TABLE

Base: 7196 Midnight Brown textured
Top: Fusion Graphite CL62

MASSAUD LOUNGE

Base: 4141 Platinum matte
Upholstery: Kvadrat Outback 466061-111

MILLBRAE CONTRACT SOFA (SPECIAL CORNER)

Kvadrat Hallingdall 65-110

MONTARA650 CAFE TABLE

Base: 4141 Platinum
Matte top: 2730 Arctic White

MONTARA650 STOOLS FULLY UPHOLSTERED

Base: 4141 Platinum matte
Seat and back: Designtex Heather 3473-801 Gull Grey

PENDANT LIGHT

T-3415LC Maine multipoint pendant
Copper finish

PILLOWS

Designtex Mohair 3575-503 Citron
Kvadrat Outback 941

SEBASTAPOL TABLE

Inner: 2001 Smokey White glossy
Applied custom color Di-noc interior
Outer: V3AK Natural Oak

THREAD HUB 30" NEMA

Plug 7360 Merle



SETTING Y

AMIA

Fully upholstered: Designtex Mingle 3491-301 Poppy
Base: 6249 Platinum

C:SCAPE STORAGE

Case: Arctic White textured 7241
Interior: Platinum 4799

FRAMEONE BENCH WITH MEDIA:SCAPE

Base: Loop leg, Platinum 4799
Top: Planked Oak worksurface 3P61
Infill and shroud: Custom applied Controltac graphic

UNIVERSAL STORAGE WITH CUSHION TOP

Cushion: Designtex Array 3578-102 Jasmine

Index

PRODUCTS & FINISHES



SETTING X



SETTING V.3

LOX STOOLS

Base: 9251 Brushed chrome
Shell: 6348 White gloss
Seat: Kvadrat Clara 2 544

MEDIA:SCAPE LOUNGE

Upholstery: Designtex Pigment 2711-304 Carmine
Table: Arctic White laminate 2730

BIVI BENCH

Top: Plank Walnut 3P71
Frame: Nickel Metallic 4728

FOOTREST

Chili plastic band 6338

SHORT CUT CHAIR

Frame: 6205 Black
Shell: 6205 Black
Shell alternate: 6259 Midnight Solar Black
Cushion: Kvadrat Coda 464480-100

Index

PRODUCTS & FINISHES



SETTING W.2

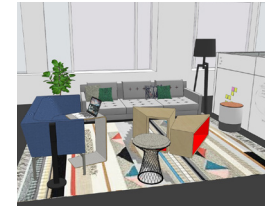

SETTING V.2

ANSWER WORKSTATION

Trim: 4799 Platinum Metallic
Fabric skins: Designtex Brushed Flannel 3797-801
Light Grey

BOUNDARY SCREEN

Type: Split and single sided
Finish: 2HAW Ash Wenge

C:SCAPE SLIM STORAGE

Case: 7236 Fog
Inner: 7278 Dark Bronze

DASH LIGHT

4799 Platinum Metallic

FOOTREST

6009 Arctic White

GESTURE CHAIRS

Scheme: Light/light
Seat and back: Kvadrat Matrix 552
Base: 4799 Platinum Metallic

MEDIA:SCAPE

Base: 4799 Platinum Metallic
Top: 2HAN Ash Noce

OLOGY DESK

Access door: 4799 Platinum Metallic
Base: 7360 Merle
Top: 2HAW Ash Wenge
Modesty: 2883 Seagull laminate

QIVI CHAIRS

Back: Qivi Net Coconut QN06
Plastic: 6249 Platinum
Solid base: 4799 Platinum Metallic
Seat: Kvadrat Remix 614

REGARD COAT HOOKS

Platinum Metallic

TECHNOLOGY

40" Monitor

UNIVERSAL STORAGE

Case: 7236 Fog
Pull: Jazz 4799 Platinum Metallic

BUOY

Finish: White
Fabric: Kvadrat Steelcut Trio 2 515

MILLBRAE SOFA

Fabric: Designtex Mohair Plus 3575 01 Mist with contrasting stitch detail Lacquer Red
Base: Black Gloss 4144

PERSONAL TABLE

Finish: 2HSW Storm Wenge laminate

RUMBLE SEAT

Fabric: Kvadrat Steelcut Trio 2 515
Base: 4B24 Night Bronze

SEBASTOPOL TABLE

Exterior: V3BK Desert Oak rift cut low sheen
Interior: 2005 Liberty Red glossy
Power: POD 6052 Milk

Index

PRODUCTS & FINISHES



SETTING V.1



SETTING W.1

ANSWER WORKSTATION

Trim: 7241 Arctic White
Slatwall skins: 7241 Arctic White
Glass skins: 6595 Winter
Veneer skins set to floor: 3HGX Quarter Cut Oak composite

LEAP CHAIR

Back: 6249 Platinum Solid
Seat/back: Elmo Rustical 91722

MIGRATION DESK

Base: 4799 Platinum Metallic
Top: 2730 Arctic White

SOTO SHELF

Finish: 4799 Platinum Metallic

UNIVERSAL STORAGE

Case: 7241 Arctic White
Front: 3HGX Quarter Cut Oak composite
Pulls: Jazz 9212 Silver
Slim shelves: 7245 Carbon Metallic

ANSWER WORKSTATION

Trim: 7225 Sand
Fabric skins: Designtex Gamut 3468-802 Pumice

BOUNDARY SCREEN

Finish: 2535 Virginia Walnut
Custom applied Controltac graphic

BRODY FOOT REST

Upper: 6527 Merle
Lower: 6059 Sterling Dark solid

BRODY WORKLOUNGE

Power: USB power
Scheme: Dark
Seat and back: Kvadrat Outback 851
Lower surround: Designtex Rothesay 3442-101 Marble
Upper screen: Designtex Gamut 3468-802 Pumice
Side surface: 2535 Virginia Walnut
Dash mini with occupancy sensor: 4AQ6 Maya Blue

CARPET

Interface floor down to earth 21-1402-05 Stone

PILLOW

Kvadrat Coda 2 762

REGARD COAT HOOK

Finish: 4750 Champagne Metallic

THINK TASK CHAIR

Frame: 7243 Seagull
Base: 7243 Seagull
Seat and back: Elmorustical L332 Honey

UNIVERSAL LAMINATE STORAGE

Finish: 2410 Virginia Walnut
Pulls: Jazz 4728 Nickel
Finish: 2535 Graphite Walnut
Pulls: Jazz 4728 Nickel
Cushion top: Kvadrat Memory 2 156

UNIVERSAL PERSONAL/MODESTY SCREEN

Fabric: Billiard 5H21 Gunmetal

UNIVERSAL PERSONAL SHELF

Finish: 4AQ6 Maya Blue

UNIVERSAL SURFACE & SUPPORTS

Top: 2410 Graphite Walnut
Tech tray: 7360 Merle
Support: FrameOne loop 7360 Merle
Intermediate support: 7225 Sand

Index

PRODUCTS & FINISHES



SETTING C.1



SETTING C.2

AMIA FULLY UPHOLSTERED CHAIR

Seat & back: Steelcut Trio Licorice Black TR06
Base: Polished

ELECTIVE ELEMENTS BIG TABLE

Gold Teak quartered composite 3GAbase: 4146
Applied custom color Di-noc to modesty panel

GESTURE CHAIR W/ HEADREST

Scheme: Light/light
Seat & back: Designtex Rothesay Charcoal 3442-803
Base: Polished

GESTURE WRAPPED BACK CHAIR

Scheme: Dark/light
Seat & back: Designtex Heather Slate 3473-803
Base: Polished

LEAP CHAIR

Shell: 6205 Black
Seat & back: Designtex Mingle 3491-806 Ink
Base: Polished

THINK CHAIR

Seat & back: Kvadrat Canvas 154
Frame: Black 6205
Base: Polished

30" THREAD HUB WITH LOW PROFILE PLUG

4799 Platinum Metallic
7360 Merle

36" THREAD HUB WITH STANDARD NEMA PLUG

4140 Arctic White gloss

DISPLAY

Face: Steelcase Laminate Seagull 2883
Top: Mohawk / Colorbeat / 976 Brushed metal

TECHNOLOGY

55" Monitor

THREAD CONNECTOR BLANK

7360 Merle

THREAD CONNECTOR NEMA

7360 Merle

THREAD CONNECTOR ONE DOOR

7360 Merle

THREAD CONNECTOR TWO DOOR

7360 Merle

Index

PRODUCTS & FINISHES

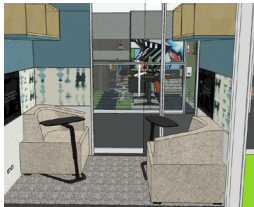

SETTING D.1

BEFREE LOUNGE

Fabric: Kvadrat Divina Melange 2 color 120

ELECTIVE ELEMENTS

Finish: 3JFX Maple composite
Cushion top: Designtex Gamut 3468 402 Cerulean

FREESTAND TABLE

Finish: 4144 Black gloss

VIA WALLS

Skins: Designtex Gamut 3468 402 Cerulean
Digital skin: Designtex digitally printed on Gamut 3468U-801 Mist

Skins: Designtex Gamut 3468 801 Mist

Veneer: 3GRX Arctic Ash



SETTING D.2

CARPET

Interface UR501 color Grass

COBI STOOL

Frame: Arctic White
Back: 3D Knit Coconut
Fabric: Designtex Mingle 3491-803 Fog

MEDIA:SCAPE KIOSK

Base finish: 4799 Platinum Metallic
Infill: 4308 Near Black
Top: 3602 Desert Oak Top

VIA WALLS

Skins: 7243 Seagull
Skins: Markerboard Grey Ceramicsteel
Veneer: 3GRX Cedan Arctic Maple on Quarter Cut Ash
Fabric: Designtex Melange 3492 502 Limelight

Index

PRODUCTS & FINISHES



SETTING U.1

BUOY

Finish: White
Fabric: Steelcut Trio 2 124

CARPET

Flor: House pet
Flor: Black cat
Flor: Frog
Flor: Chinchilla

OLOGY

Integrated rail
Frame: 7630 Merle
Top: Special Ash on Oak VP03 rift cut / low sheen
Modesty panel: Brushed Flannel 3797 702 Flame

TECHNOLOGY

55" Microsoft Surface Hub
Surface Studios
Surface Pro

THINK STOOLS

Frame: Seagull
Base: Polished aluminum
Back: 3D Knit Nickel mesh
Fabric: Kvadrat Highfield 2 651

UMAMI LOUNGE

Fabric: Kvadrat Basel123
Slice fabric: Boucle two-tone 3751 802 Charcoal
Base: Lux coating 4E20 Obsidian

UNIVERSAL STORAGE

Laminate: 2536/2516 Blackwood
Pull: Jazz Black paint
Bookcase: 2746 Black laminate
Common top: 2536 Blackwood
Slim shelf: 72BW Ditzler Orange texture

VIA WALLS

Skins: 801 Brushed Flannel
Skins: 7360 Merle
Markerboard: Polyvision Ceramicsteel 61015 E3 Light Grey low gloss (special)
Skins: Perfect match 4AYO Crocodile
Frame: 7630 Merle
Magnet tiles: 12"x18" Leather Elmo Rustical VI 93327
Graphics: Designtex VM printable magnet

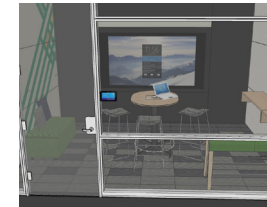

SETTING U.2

BEFREE PONY BENCH

Fabric: Kvadrat Meadow 975

CARPET TILE

Interface net effect 124970akoo: 103961 Black Sea
Interface net effect 124970akoo: 103966 Caspian

COAT HOOKS

Blu dot

ELECTIVE ELEMENTS STORAGE

Custom stain: 3FCD Rift Cut Oak Open Pore low sheen

LAGUNITAS POWER POD

White

LAST MINUTE STOOL

Base: Polished Aluminum base
Fabric: Designtex Bute Storr 3806 801 Grey

PILLOWS

13 x 13" Designtex Bute Braemar 3802 101 Creme
24 x 6" Designtex Bute Braemar 3802 701 Terra Cota
18 x 18" Designtex Bute Lewis 3803 802 Chickadee
10 x 13" Designtex Mohair Plus 3575 801 Mist

SCAPE ELLIPSE TABLE

Custom stain: 3FCD Rift Cut Oak Open Pore low sheen
Base paint: 7246 Midnight Metallic

TECHNOLOGY

86" Microsoft Surface Hub
Surface Book | Surface Pro
RoomWizard
Virtual PUCK

VIA WALLS

Skins: Designtex Brushed Flannel 3797 101 Creme
Skins: 4843 Linen
Skins: 6591 Merle Backpainted glass
Custom applied cut vinyl graphic

Index

PRODUCTS & FINISHES



SETTING T

AWAIT OTTOMANS

Fabric: Designtex Plaid 3782-301 Robin

BIG LAMP

Fabric: 5S24 Cogent Connect Nickel

Base: 9211 Nickel

BRODY WORKLOUNGE

Seat upholstery: Designtex 3803 501 Hunter

Screen: Billiard 6541 503 Hunter

Seat upholstery: Designtex 3803 802 Chickadee

Screen: Billiard 6541 401 Mallard

C25 PADDLE CHAIR

Frame: 3265 Oak White Oil

Seat and back: P501 Natural Papercord

CG.1 TABLE

Top: V3BK Desert Oak low sheen

Legs: 4242 Milk smooth

ELECTIVE ELEMENTS BIG TABLE

Finish: 3P61 Planked Oak

MONTARA650 STOOLS

Base: Chrome

Veneer: Black Oak

Fabric: Coda 2 232

RUMBLE SEAT

Upholstery: Kvadrat Canvas 614

Base: Arctic White



SETTING R

AIR TOUCH TABLE

Top veneer: Flat Cut Maple composite 3JFX

Edge: Chamfer

Base: 7246 Midnight Metallic

BUOY

Base: White

Fabric: Kvadrat Steelcut Trio-133

GESTURE CHAIR

Scheme: Dark/light

Seat and back: Designtex Rocket with Etro pattern

Base: 4799 Platinum Metallic

HD STORAGE

Top veneer: Flat Cut Maple composite 3JFX

Bag drop with coat closet

Pull: Nile Chrome

Interior: 4AZ5 Marlin

TECHNOLOGY

Surface Studio

Surface Pro

VIA WALLS

Skins: 7243 Seagull

Skins: Midnight

Glass markerboard: Winter 6595

Appliqué: Cork

Index

PRODUCTS & FINISHES



SETTING S

DASH LIGHT

Finish: 4AQ9 Scarlet

ELECTIVE ELEMENTS STORAGE

Finish: Dark Cerused Oak

MASSAUD LOUNGE CHAIR

Fabric: Circa 3419 802 Coal

Base: Low Gloss Black

Back: Elmosoft Ebony

THREAD

Finish: 7360 Merle

VIA

Skins: 4242 Milk with Designtex Controltac



SETTING Q

CARPET

Lees Enthralled - Allured

C:SCAPE STORAGE

Case: 7360 Merle

Interior: 72BW Ditzler Orange texture

MEDIA:SCAPE TABLE

Base: 4799 Platinum

Top: 3F8X Brookline Walnut European with custom graphic

THINK STOOLS

Frame: Platinum

Back: 3D Knit Nickel

Fabric: Steel Cut Trio TR08 Red Currant

VIA WALLS

Skins: Designtex Rocket 2693 801 Graphite

Seals: Merle

Index

PRODUCTS & FINISHES



SETTING O



SETTING N

CARPET

Finish: Interface World Woven WW860 128190AK00 - Color 105351 Linen Tweed
Accent Carpet: Interface Monochrome 138570250H - Color 101825 Berry

COAT RACK

Blu dot splash
Finish: Putty Grey

COBI CHAIR

Frame: White
Base: Polished
Mesh back: Nickel
Fabric: Designtex Mingle 3491-803 Fog

ELECTIVE ELEMENTS

Finish: 3E8X Houtline Oak
Glass: 6585 Fuchsia

GESTURE CHAIR

Wrap back
Scheme: Light/dark
Seat and back: Elmosoft L709 Sugar
Base: Polished

LAST MINUTE STOOLS

Base: 9207 Polished Trivalent Chrome
Fabric: Elmosoft 11049 Dove Grey

MEDIA:SCAPE

Base: White Gloss base
Top: 3E8X Houtline Oak

MONTARA650 TABLE

Base: 4180 Graphite Matte
Top: 2730 Arctic White

TECHNOLOGY

(2) 55" Displays

VIA WALLS

Veneer: 3E8X Houtline Oak
Skins: Markerboard
Skins: Perfect match
Seals: Merle

DENIZEN TABLE

Base: Platinum Gloss
Corian solidsurface

FLEXFRAME STORAGE

Wood: 3GGX Zebrano Composite
Glass: 6595 Winter
Pull: Nile Polished Chrome

GESTURE CHAIR

Scheme: Light/light
Seat and back: Designtex Heather 3473 501 Lambs Ear
Base: 4799 Platinum Metallic

VIA WALLS

Painted Steel: 4788 Gold Dust Metallic
Wood: 3GGX Zebrano Composite
Vertical fabric: Plane Jane 5F94 Blizzard
Slatwall: 4799 Platinum

Index

PRODUCTS & FINISHES



SETTING M



SETTING L

AWAIT BENCH

Finish: Designtex Opulent 3456 802 Gull

CARPET

Tandus Spun Felt Noir 38201

CONVENE TABLE

Finish: 3062 Flat Cut Open Pore Graphite Walnut 3062

ELECTIVE ELEMENTS STORAGE

Finish: 3062 Flat Cut Open Pore Graphite Walnut 3062
Pull: Beam 7278 Dark Bronze

FLOOR LAMP

Wo-turn-bo Floor lamp - Large

MASSAUD CONFERENCE MID BACK

Base: Aluminum Matte polished
Back: Elmosoft Leather L709 Sugar
Inner: Remix RE08 Concrete Grey

VIA WALLS

Skins: 3062 Flat Cut Open Pore Graphite Walnut 3062
Glass: 6500 Clear with Designtex privacy film

WALL HOOK

Blu dot Wook Wall hook - Red

FLEXFRAME DESK + STORAGE

Veneer: 3042 Quarter Cut Open Pore Ash
Fabric: Designtex Gamut 3468 803 Pebble
Glass: 6589 Mercury Special to be magnetic

QIVI CHAIR

Back: Qivi Net Graphite
Plastic: Arctic White
Seat: Remix RE03 Pebble

Index

PRODUCTS & FINISHES

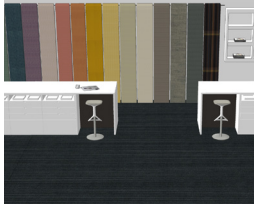

SETTING A

ELECTIVE ELEMENTS STORAGE

Finish: Arctic White laminate 2730

Pulls: Scallop + integral

ELECTIVE ELEMENTS TABLE

Finish: Arctic White laminate 2730

Di-noc inset: Grey Lacquer HG-1512

LOX STOOL

Seat: Designtex: Array 3578-102 Jasmine

Base: White



SETTING G.1

FLEXFRAME WALL

Wood: Dark Cerused Oak

Glass: 6592 Asphalt

Metal accent: 7246 Midnight Metallic

Pull: Inset

LOX STOOL

Base: White

Fabric: Designtex Plaid 3782 101 Sparrow

Index

PRODUCTS & FINISHES

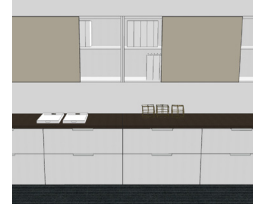

SETTING G.2

ELECTIVE ELEMENTS DOUBLE HIGH

Doors: Sliding

Glass: 6592 Asphalt

Laminate: 2730 Arctic White

Metal details: 4803 Near Black Metallic

ELECTIVE ELEMENTS LATERAL FILES

Laminate: 2730 Arctic White

Wood wrap: Dark Cerused Oak

Pull: Inset Arctic White



SETTING F

ELECTIVE ELEMENTS STORAGE

Wood: 3P61 Planked Oak

Base: Groupworks 7246 Midnight Metallic

Pull: Integral

Solidsurface - by Evans + Paul Hi Macs/Ivory White

MONTARA650 STOOLS

Base: 4148 Graphite Matte

Upholstery: Designtex Barkcloth 3746-402 Navy

PENDANT LIGHT

Blu dot Trace 4

Index

PRODUCTS & FINISHES



SETTING E

AWAIT OTTOMAN

Base: Aluminum
Glass: Absolute clear

CH53 STOOL

Finish: Oak Oil finish/Natural Paper Cord

CH401 AIRPORT CHAIR

Leather: CH Thor 307

ELECTIVE ELEMENTS STORAGE

Wood: 3P61 Planked Oak
Base: Groupworks 7246 Midnight Metallic

EMU HEAVEN TABLE

Base: 4256 Aluminum
Glass: 6548 Smoke

FLOOR LAMP

Blu dot: Stilt floor lamp
Finish: White/Ash Grey

RUG

Blu dot: Collet area rug Grey

SWITCH SOFA

Fabric: Designtex Hashtag 3662 102 Epia
Bolsters: Designtex Lambert 3623 801 Fog

THREAD

Finish: 7360 Merle



SETTING K.1 & K.2

PRIVACY WALL

Finish: 7278 Dark Bronze
Glass: 6500 Clear glass

Index

PRODUCTS & FINISHES



SETTING K.2

ELECTIVE ELEMENTS DESK + STORAGE

Finish: 3GAX Gold Teak composite
Glass: 6521 Truffle
Backboard glass: 6592 Asphalt
Pull: Inset
Leg: Gate

GESTURE CHAIR

Scheme: Dark/light
Seat and back: Wrapp back Designtex Mingle 3491 503 Reed

MONTARA650 CHAIRS

Base: 4710 Low gloss Black
Fabric: Designtex Hint 3776 502 Sea Green

WALLCOVERING

Designtex Triangle pattern: Ref. Pattern 15-0008046
Felt AM003 Lambs ear



SETTING K.1

ALIGHT OTTOMAN

Finish: Designtex Lambert 3623 802 Smoke

ARTWORK

Elizabeth Cecile

DESIGNTEX WALLCOVERING

Wannabe Rib 5622 101 Gull

ELECTIVE ELEMENTS DESK + STORAGE

Finish: 2HAN Ash Noce laminate
2730 Arctic White laminate
Pull: Nile polished chrome
Leg: Column

PILLOWS

By: Iza Furman LLC
Fabric: Designtex Hint 3776 401 Light Blue

PRIVACY WALL

Finish: 7278 Dark Bronze

SW_1 TABLE

Base: Aluminum matte
Top: Absolute Clear with Moonlight

THINK TASK CHAIR

Finish: 7243 Seagull
Fabric: Designtex Mingle 3491 407 Mist

TOGETHER BENCH

Fabric: Designtex Savile Plaid 3519 802 Steel

Index

PRODUCTS & FINISHES

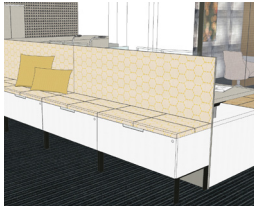

SETTING J

ANSWER BOUNDARY SCREEN

Inset glass
Finish: 2HCW Clay Wenge

BACK CUSHION

By: Tomas M. Amato, Inc.

ELECTIVE ELEMENTS LOCKERS

Finish: 2HCW Clay Wenge
Finish: 2730 Arctic White
Pulls: Inset 4803 Near Black Metallic
Fabric: Designtex Savile Plaid 3519 802 Steel
Lockers: Digi-lock

ELECTIVE ELEMENTS STORAGE

Cushion top:
Legs: 4803 Near Black Metallic
Pulls: Inset Arctic White
Cushion: Designtex Mod 3713 201 Daisy
Storage cushion top:
Designtex Hashtag 3662 201 Dandelion

OLOGY DESKS

Top: 2HCW Clay Wenge
Base: 4803 New Black Metallic

PILLOWS

By: Iza Furman LLC
Fabric: Designtex Hint 3776 201 Canary



SETTING H.2

ARTWORK

Art by Michael Muller
Designtex image ref. 15-0006313
Designtex chromaluxe sub-straight

ELECTIVE ELEMENTS DESK + STORAGE

Finish: 38KN Quarter Cut Walnut Open Pore low sheen
Glass: Magnet 6589 Mercury
Pull: Beam Platinum Metallic

GLASS SELECTIONS

Finish: 7245 Carbon Metallic
Film: Designtex 15-0006916

MASSAUD GUEST CHAIR

Finish: Silver
Fabric: Designtex Tweed Multi 3722 301 Pink

MASSAUD TASK CHAIR

Finish: Silver
Fabric: Elmo Soft 93068 Cinder

WALLCOVERING

Finish: Designtex Burnish Mid Grey 6678-801

Index

PRODUCTS & FINISHES



SETTING H.1

DAVOS BENCH

Fabric: Designtex Starburst 3748 101 White
Designtex Samba Otra Vez 2885 407 Tapestry

ELECTIVE ELEMENTS STORAGE

Finish: 3F8X European Walnut Composite
Glass: 6509 Mirror Bronze
Solid surface: Evans + Paul Viatera/Rococo

ENEA LOTTUS TABLE

Base: Black
Top: 3F8X European Walnut (stain to match)

GESTURE STOOL

Scheme: Dark/dark
Seat and back: Designtex Tweed Multi 3722 802
Medium Grey

MEDIA:SCAPE TABLE

Finish: 3F8X European Walnut Composite
Base: 4803 Near Black Metallic

MONTARA650 STOOL

Frame: Low Gloss Black
Fabric: Designtex Starburst 3748 101 White
Designtex Samba Otra Vez 2885 407 Tapestry

WALLCOVERING

Made to measure: Desert Moon
Finish: Glint 5619 101 Snowfall

WHITEBOARD

Polyvision E3 Steel Whiteboard

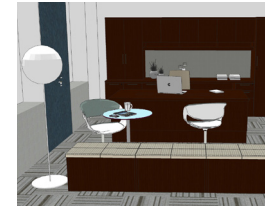

SETTING U.3

BOB TABLE

Base: Silver
Glass: Absolute Clear

ELECTIVE ELEMENTS

Finish: 365N Walnut Veneer Full Fill High Sheen
Vertical fabric: Plain Jane 5F72 Petoskey
Pulls: Nile 7278 Dark Bronze
Cushion top: Designtex Ainsley 3636 101 Opal

LEAP CHAIR

Finish: Light/light (platinum)
Fabric: Brisa BR19 Cream

LOX CHAIR

Base: Polished Aluminum
Fabric: Designtex Reppweave 3747 401 Medium Blue

WALLCOVERING

Designtex Wannabe 6646 401 Blue Jay

4 Columbus Circle
New York, NY 10019

Steelcase®